

## Installation kit softliQ

### Intended use

The installation kit softliQ is designed for a combination connection of a Grünbeck water softener softliQ:SD18, SD21, SD23 and softliQ:MD32 and a Grünbeck filter (size 1") of the pureliQ and BOXER series.

Additional filter combinations with e.g. safety device protectliQ are possible.

The installation kit softliQ is intended for installation situations with limited space in a water pipe.

The installation kit softliQ can be installed in horizontal or vertical water pipes.

The installation kit softliQ is suitable for an installation length of 100 mm in the water pipe DN 25 (1") in size.

The installation kit softliQ is suitable for the flow direction of water from right, left, top or bottom.

### Function

The raw water flows through the filter (e.g. pureliQ) and is transported to the water outlet side (soft water) via the integrated connection block of the water softener softliQ.

### Design

- The connection block of the installation kit softliQ is mounted in the line connection of a filter pre-installed on site.
- The filter is mounted on the connection block of the installation kit and connected to the softliQ connection block.
- The water softener softliQ is connected to the connection block with connection hoses.
- The connection hose of the installation kit softliQ is integrated into the water pipe.
- A pipe clamp fixes the installation kit softliQ to the wall and ensures stability.

### Installation

- Simple, fast and space-saving.
- Installation without special tools.
- Cost-effective installation option, as no additional intervention in the water pipe is necessary.

### Scope of supply

- Connection block (for 100 mm installation length without screw connections)
- Flat gaskets (4x white, 2x black)
- Double screw connection and transition piece
- Pipe clamp with hanger bolt
- 1" flexible connection hose (with screw connections and O-rings)

### Optional

- Corrugated stainless steel pipe (version for Switzerland)

## Technical specifications I

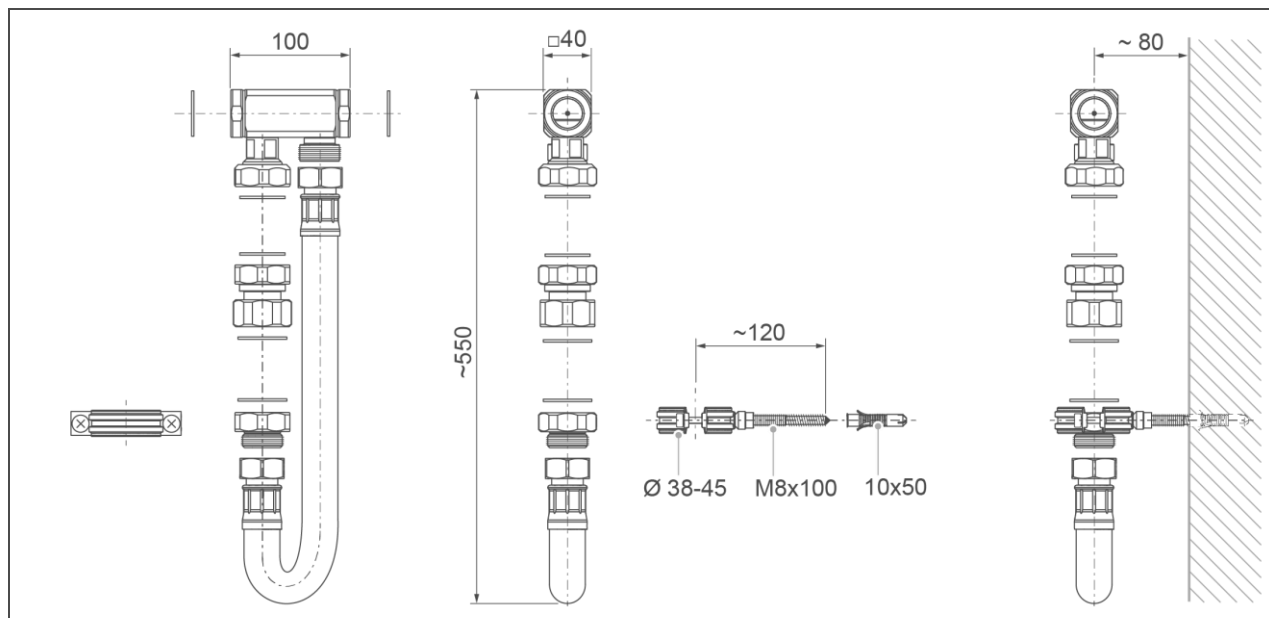

### Dimensions and weights

Nominal connection diameter	DN	25
Installation length	mm	100
Distance to wall	mm	approx. 80
Shipping weight, approx.	kg	2.3

### Performance data

Nominal pressure	PN	10
Nominal flow	m³/h	1.8 – 3.2
Pressure loss at nominal flow	bar	approx. 0.5
Min./max. operating pressure (recommended)	bar	3.0 – 8.0 (4.0)

### General data

Water temperature	°C	5 – 30
Ambient temperature	°C	5 – 40
<b>Order no.</b>		<b>188 865</b>

## Installation example I

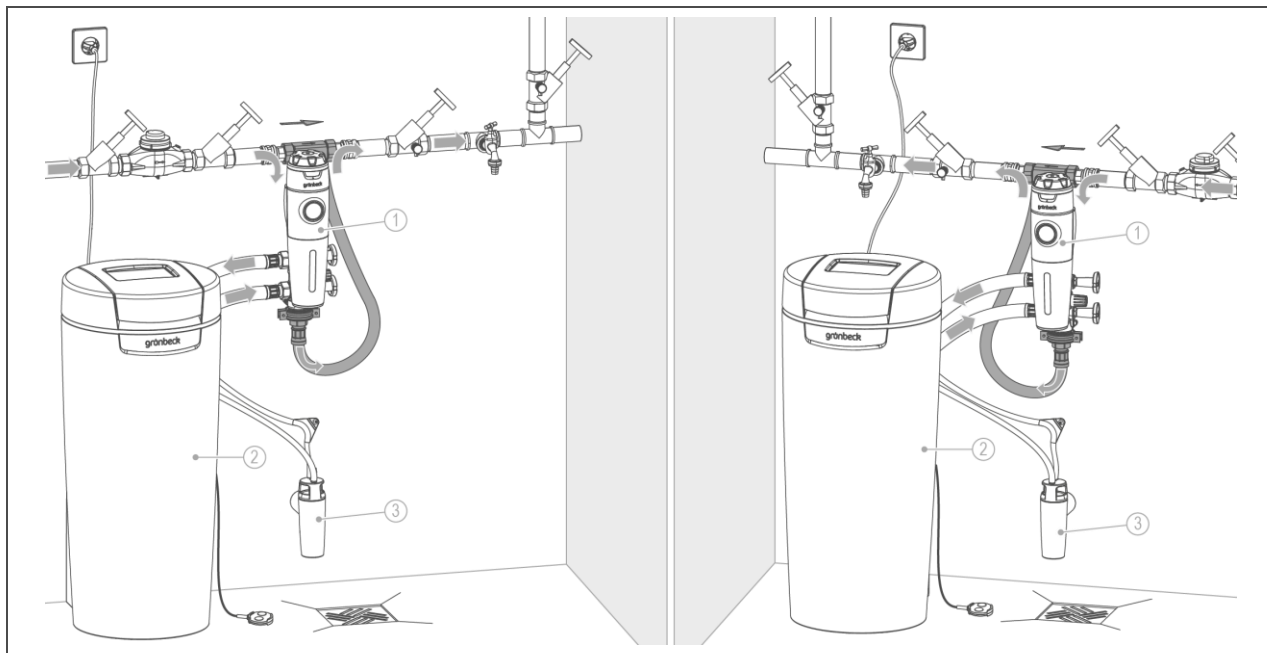

Item	Designation	Item	Designation
1	Fine filter, e.g. pureliQ:KD (1")	2	Water softener softliQ (DN 25)
3	Drain connection DN 50 acc. to DIN EN 1717		

## Installation example II

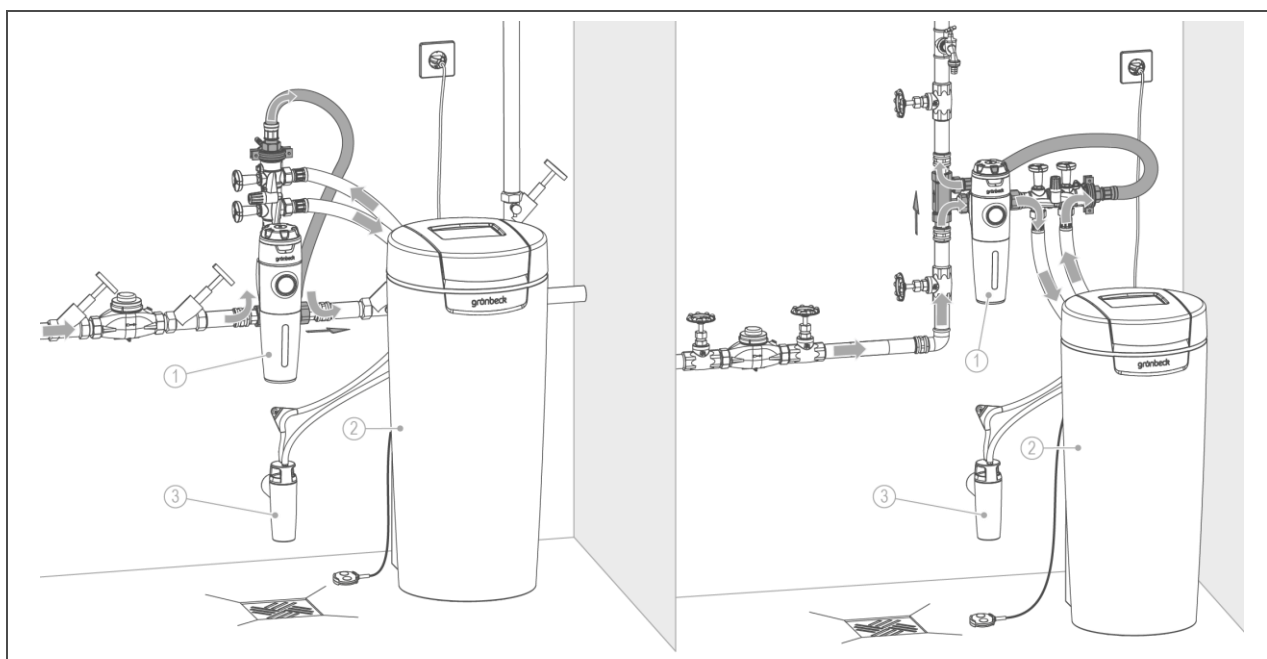

Item	Designation	Item	Designation
1	Fine filter, e.g. pureliQ:KD (1")	2	Water softener softliQ (DN 25)
3	Drain connection DN 50 acc. to DIN EN 1717		

### Installation example III (protectliQ:A & pureliQ:KD)

### Installation example IV (protectliQ:A & pureliQ:KD & softliQ:SD)

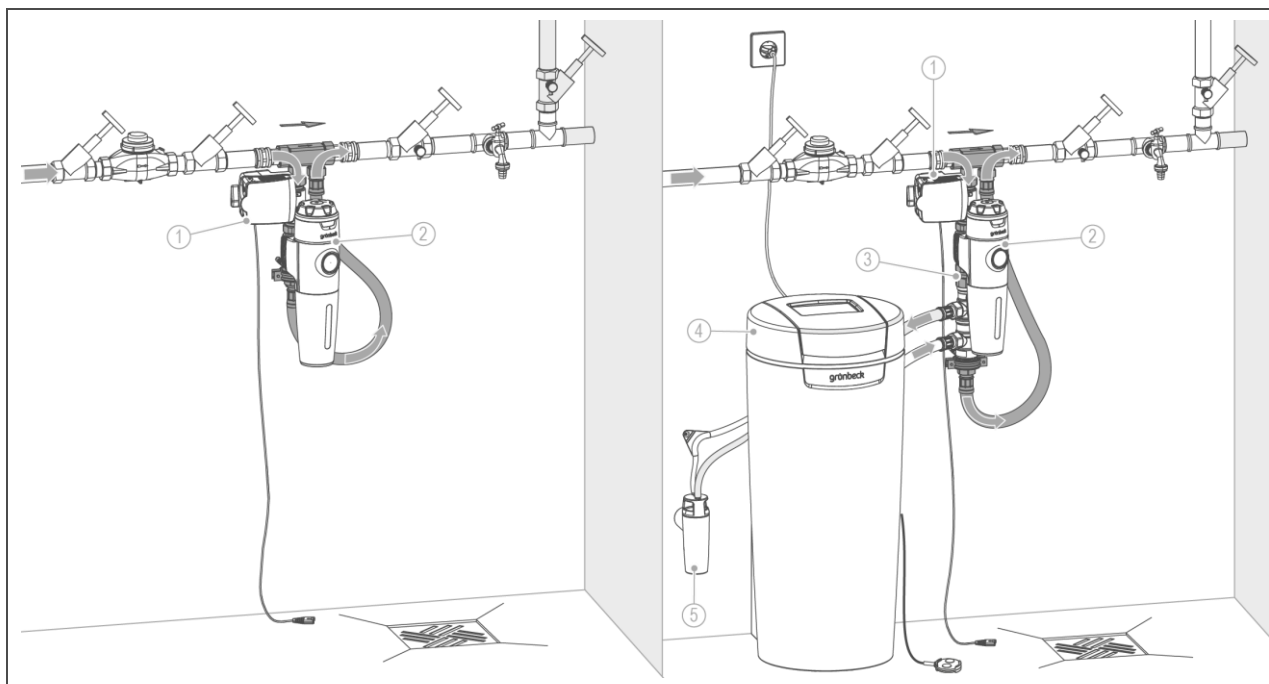

Pos.	Bezeichnung	Pos.	Bezeichnung
1	Safety device protectliQ:A25 (1")	2	Fine filter, e.g. pureliQ:KD (1")
3	Twin connection order no. 115 334 (not in the scope of supply)	4	Water softener softliQ (DN 25)
5	Drain connection DN 50 acc. to DIN EN 1717		

### Installation requirements

Pre-installed on-site filter in water pipe size DN 25 (1").

Pre-installed water meter screw connections (from the on-site filter) with 100 mm installation length for connection block of the installation kit.

### Note on Installation example IV: Installation kit with protectliQ & pureliQ & softliQ

- Additional twin connection required  
(Order no. 115 334)

### Contact

Grünbeck Wasseraufbereitung GmbH  
Josef-Grünbeck-Str. 1  
89420 Hoechstädt  
Germany

☎ +49 (0)9074 410

☎ +49 (0)9074 41-100

info@gruenbeck.com  
www.gruenbeck.com

